



STOR-EDGE™ CABINET GROUPINGS

Name:	
School/Organization:	
Dealer/Rep:	

Phone:	
E-mail:	
Sales Rep:	Quote:

STANDARD GROUPINGS:

SEMCG1
Overall Dimensions:
49"W x 18"D x 36"H
QTY:

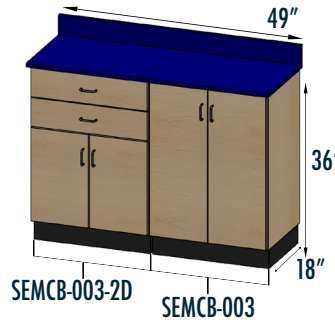

SEM CB-003-2D SEM CB-003

(1) SEMCB-003-2D
49"W x 18"D x 36"H
• (1) Adjustable Shelf
• (2) Hinged Doors
• (2) 5.5" Drawers

(1) SEMCB-003
• 24"W x 18"D x 36"H
• (1) Adjustable Shelf
• (2) Hinged Doors

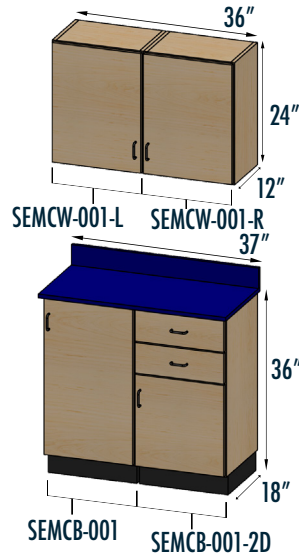

SEM CW-001-L SEM CW-001-R

SEM CB-001 SEM CB-001-2D

SEMCG2
Overall Top Dimensions:
36"W x 12"D x 24"H
Overall Bottom Dimensions:
37"W x 18"D x 36"H
QTY:

(1) SEMCB-003-2D
• 24"W x 18"D x 36"H
• (1) Adjustable Shelf
• (2) Hinged Doors
• (2) 5.5" Drawers

(1) SEMCB-003
• 24"W x 18"D x 36"H
• (1) Adjustable Shelf
• (2) Hinged Doors

(2) SEMCW-003
• 24"W x 12"D x 24"H
• (1) Adjustable Shelf
• (2) Hinged Doors

STANDARD FEATURES:

- Available in wood or laminate finishes
- 1 Adjustable shelf in each cabinet
- 110° Euro hinges on doors
- Black wire pull handles
- Full extension drawers glides
- High pressure laminate countertop with backsplash
- Black toe-kick plate
- Mounting hardware not supplied
- Cabinets ship individually without countertop installed assembly and installation required on site



STOR-EDGE CABINET GROUPINGS

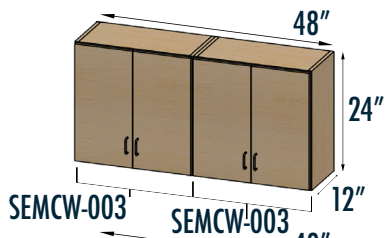

○ SEMCG3
 Overall Top Dimensions:
 48" W x 12" D x 24" H
 Overall Bottom Dimensions:
 49" W x 18" D x 36" H
 QTY:

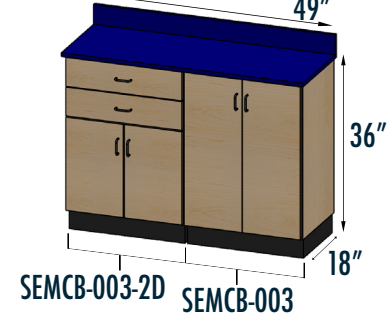

(1) SEMCB-003-2D
 • 24" W x 18" D x 36" H
 • (1) Adjustable Shelf
 • (2) Hinged Doors
 • (2) 5.5" Drawers

(1) SEMCB-003
 • 24" W x 18" D x 36" H
 • (1) Adjustable Shelf
 • (2) Hinged Doors

(2) SEMCW-003
 • 24" W x 12" D x 24" H
 • (1) Adjustable Shelf
 • (2) Hinged Doors

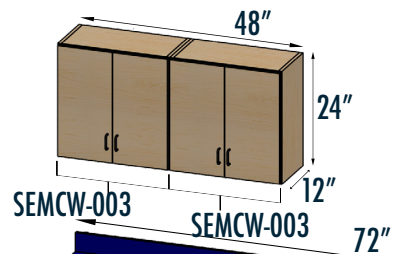

○ SEMCG4
 Overall Top Dimensions:
 48" W x 12" D x 24" H
 Overall Bottom Dimensions:
 72" W x 18" D x 36" H
 QTY:

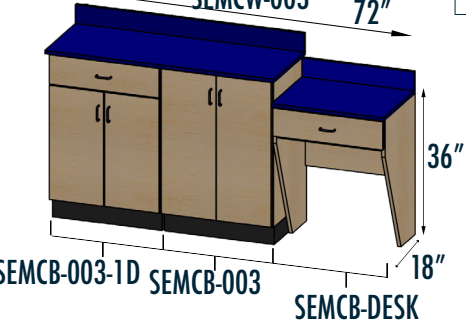

(1) SEMCB-003-1D
 • 24" W x 18" D x 36" H
 • (1) Adjustable Shelf
 • (2) Hinged Doors
 • (1) 5.5" Drawers

(1) SEMCB-003
 • 24" W x 18" D x 36" H
 • (1) Adjustable Shelf
 • (2) Hinged Doors

(2) SEMCW-003
 • 24" W x 12" D x 24" H
 • (1) Adjustable Shelf
 • (2) Hinged Doors

(1) SEMCB-DESK
 • (1) 5.5" Drawers



STOR-EDGE CABINET GROUPINGS

OPTIONS:

- Lock1004 - Lock on Single Door
- Lock Double Door - Lock on Double Door
- Lock1001 - Lock on Drawer (Not Available with Flush Mount Handles)
- TSFO-FHDR - Flush Mount Handles on Drawers
- TSFO-FHD - Flush Mount Handles on Doors
- TSFO-FHSD - Flush Mount Handles - Single Door



STANDARD WOOD COLORS:

-  Oak
-  Maple





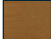
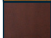

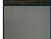
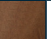
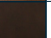
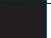
WOOD STAIN OPTIONS:

- MOD-Stain







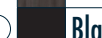

STANDARD STAIN COLORS:

-  Warm Copper
-  Deep Garnet
-  Fossil Gray
-  Tungsten
-  Rustic Fall
-  Warm Caramel
-  Black Beauty
- Custom Wood Stain Color:

STANDARD LAMINATE COLORS:

-  Oak
-  Maple
-  Cherry Merlot
-  Espresso
-  Grey
-  Storm Grey
-  Harbor Grain
-  Black

STANDARD COUNTERTOP COLORS:

-  Brittany Blue
-  Navy Blue
-  Burgundy
-  North Sea Grey
-  Black
-  Royal Blue
-  Red
-  Hunter Green
-  Slate Grey



SEMCG3

CUSTOM BRANDING:

- Decal Custom Small
Small Logo Decal
(6"W x 6"H) 
- Decal Custom Large
Large Logo Decal
(12"W x 12"H) 